

Band Reject Filters



RLC Electronics' Customized Band Reject Filters are designed to operate over the frequency range of 10 to 12,000 MHz. These filters are characterized by having the reverse properties of band pass filters. The filters are available in compact sizes and

are constructed to operate over the most severe military environmental conditions. The 3 dB band reject band-widths may be chosen from 0.5 to 15% of the center frequency. They are available with a choice of the 2 through 9 sections.

Specifications

BRF-1-2-3-4

Model Number	Center Frequency Range (MHz)	3 dB Bandwidth (% of fc)	Number of Sections	3 dB Bandwidth 40 dB Ratio
BRF	10 to 12,000	0.5 to 15.0	2	30
			3	7
			5	3.4
			7	2.7
			9	2.3

VSWR: 1.5:1 DC to 2 x fc <6000 MHz

1.8:1 DC to 2 x fc >6000 MHz

Insertion Loss: 1dB maximum

Connectors: Female

Type Recommended Freq Rng, MHZ:

N DC-12,400

BNC DC-1,000

TNC DC-15,000

SMA DC-26,000

Power Rating: 25 watts

Environment: MIL-E-5400, Class 1A

Impedance: 50 ohms

To designate the filter desired use:

(1) Center Frequency in MHz

(2) 3 dB Bandwidth in MHz.

(3) Number of Sections

(4) "N" for type N, "B" for BNC, "T" for TNC and "R" for SMA

Example: BRF-50-5-4-R is a 50 MHz center frequency, 5 MHz 3 dB bandwidth, 4 section, Band reject filter with SMA(f) connectors.

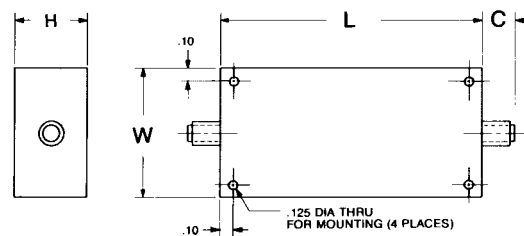

Outline Drawing

Center Frequency (MHz)	Approximate Dimension Table		
	W	H	L (N is the number of sections)
10 to 1000	1.0	0.75	$N * .5 + 1.5$
1000 to 6000	$\frac{2950}{fc (MHz)} + 1.0$	0.63	$\frac{2950}{fc (MHz)} * N + .36$
6000 to 12,000	$\frac{5900}{fc (MHz)} + 1.0$	0.50	$\frac{2950}{fc (MHz)} * N + .36$

CONNECTORS	R	N	T/B
"C" Dimension	.30	.60	.52

Tolerances unless otherwise specified are:
.xx, ±.02; .xxx, ±.005.

